



THANECOAT W300

One Component Liquid Applied Polyurethane Waterproofing Membrane

單組份液態應用式聚胺脂防水塗膜

1.0 Description

THANECOAT W300 is a high performance elastomeric, one component, moisture curing polyurethane waterproofing membrane with excellent quality and performance for waterproofing on concrete, which is also formulated for waterproofing membrane embedding underneath C/S, Tiles or other construction finish.

2.0 Technical Data

*Based on Test report No. 040123ST40693 and 040123CH40701 of MaterialLab, a recognized Laboratory under HOKLAS Accreditation Scheme

	Tested Value	Test Method	Equipment (if any)
Adhesion Strength (without PRIMER)	1.33 N/mm ²	ASTM4541:95	Pull-off tester
Density	1.3 kg/M ³	ISO1183:1987	T-017-5
Water Absorption (%)	0.75 %	Method 620A to 600D:1991	-
		ASTM570-81	OVEN: T-025-6
Tensile Strength	3 N/mm ²	BS2782pt3	Water Bath: T-057-7
		Method 320A to 3207:1976	UTM: T-019-2
Elongation at break (%)	600%	DITTO	DITTO
Hardness Scale (Shore A)	46	ASTM2240-00	T-102-1
Anti-corrosion Test (Salt Spray Test)	Passed	BS3900:F12:1997	-
VOC Content	72 g/L	(USEPA Method 24 & SCAQMD 303-91)	-
Other In House Test			
Moisture Vapour Transmission	4.235 gms	per m ² /24 hours ASTM E108	-
Weather meter	2000 hrs	Still pliable, no loss of general properties	-
Abrasion Resistance Standard	Suitable for traffic	ASTM C501	-
Fire Resistance	Class A	ASTM E108/UL 790	-
Crack Bridging	1.8mm		

3.0 Typical Application

THANECOAT W300 is a single application product for use on new or old roofs, Terraces, Podium, pool, tunnels, foundation wall and planters. It can be applied to most surfaces; asphalt, concrete, roofing felt, asbestos, iron sheeting, slate, claytiles, gutters etc.

4.0 Application Details

Preparation :

- All surfaces should be sound, clean, dry, free of dust, oil, grease or other contamination. Loose matter should be removed by abrasion, compressed air or high-pressure water.
- Concrete Surface should have a light steel towel finished or being made flat by a layer of cement/sand screed (Sufficient time for curing C/S should be given before laying .of THANECOAT)
- All Shrinkage and non-moving structural crack under 1.6mm (1/16-inch) shall be pretreated with one coat of THANECOAT.
- All right angle joints between parapet wall and slabs should be treated with cementitious fillet.



5.0 Application Details

Job Diagrams:

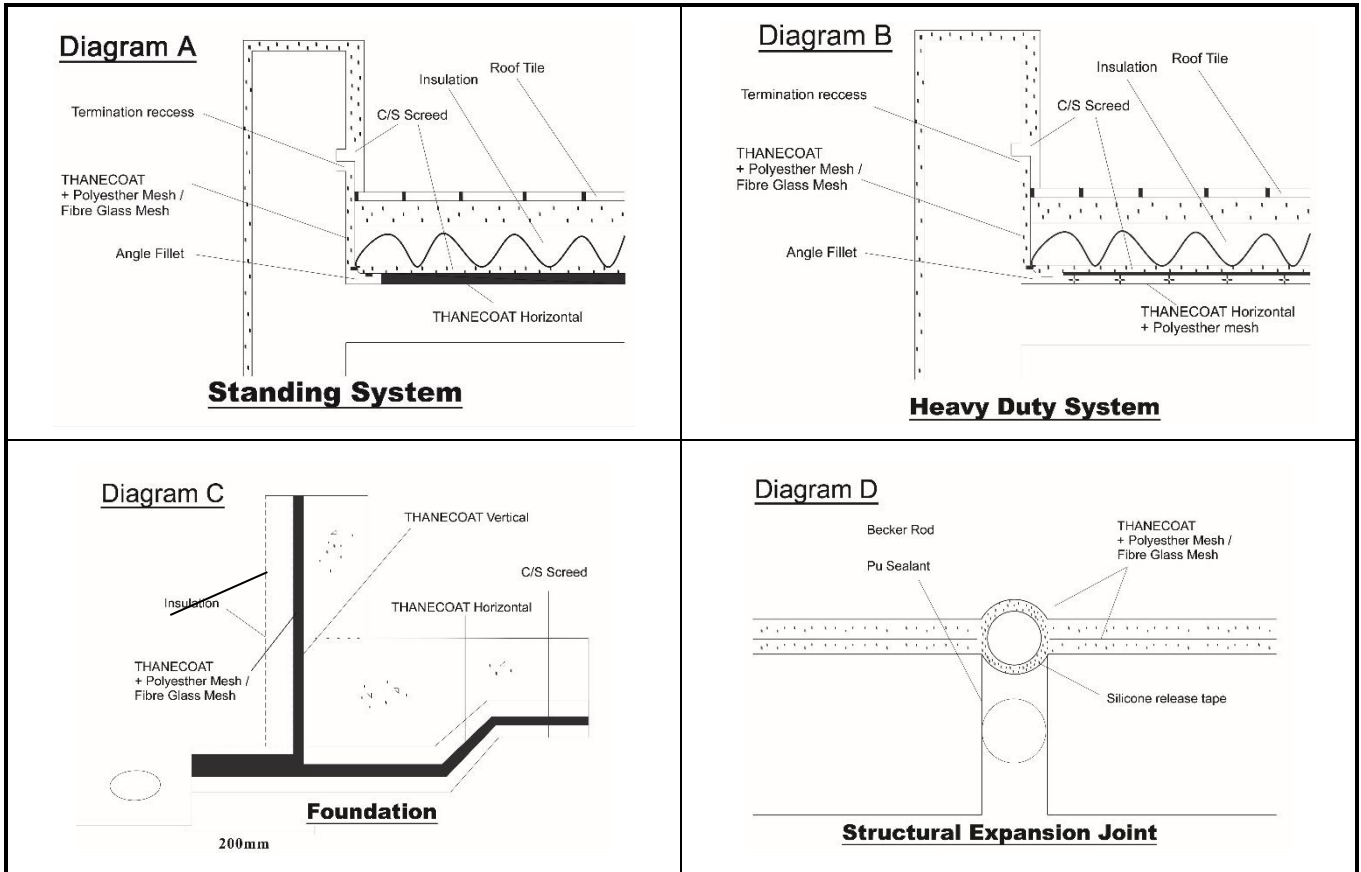

Standing System (Diagram A):

- A) 2 coats of THANECOAT (Vertical grade)+ 1 layer of MPMESH A900 or A901 to Skirting, Kerb and/or any vertical surfaces.
- B) Horizontal Grade THANECOAT shall be applied, by trowel or squeegee, directly to the horizontal surface to achieve a thickness not less than 1.5mm

Heavy Duty System (Diagram B):

- A) 2 coats of THANECOAT (Vertical grade) + 1 layer of MPMESH A900 or A907 to Skirting, Kerb and/or any vertical surfaces.
- B) 2 coats of THANECOAT (Horizontal grade) + 1 layer of MPMESH A900 or A907 to the horizontal surface.

Expansion joint & Foundation please refer to Diagram C & D

6.0 Coverage

Standing System --- @ 1.8 – 2.0 kg / M2 Approx.

Heavy Duty System ---- @ 3.6 – 4.0 kg / M2 Approx.

*Vary from surface condition.

7.0 Health and Safety

THANECOAT W300 contains aromatic solvents and is harmful to eyes and skin. Use old or protective clothing and rubber gloves. When spraying, use face visors. Do not smoke in vicinity and allow adequate ventilation.

8.0 Cleaning

Tools can be cleaned after use in any aromatic solvent.

9.0 Packaging

18kg/Drum